

USER MANUAL

CELLPOWER HYDROGEN WATER BOTTLE



LUMIVITAE



CAUTION Non-compliance with the provided instructions may result in product damage or malfunction, which is not covered by the warranty. Please take the time to carefully review the entire manual to ensure proper use and avoid any issues.

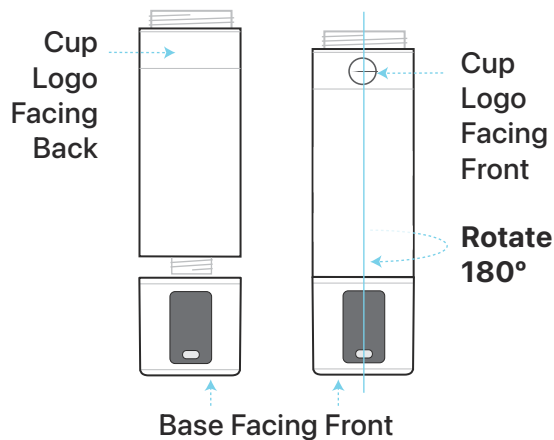

When assembling the cup, position the logo to the back and rotate the cup on the base by 180 degrees so that it faces the front, aligning with the screen on the base.

Do not force!

This may lead to component breakage.

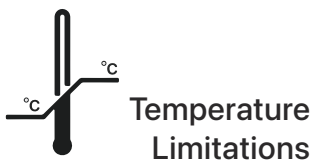

Never place the bottle in environments with extreme temperatures (e.g., **sauna, refrigerator, freezer, etc.**) and **never submerge it in liquid or any other solution** (remember, it's water-resistant but not waterproof).

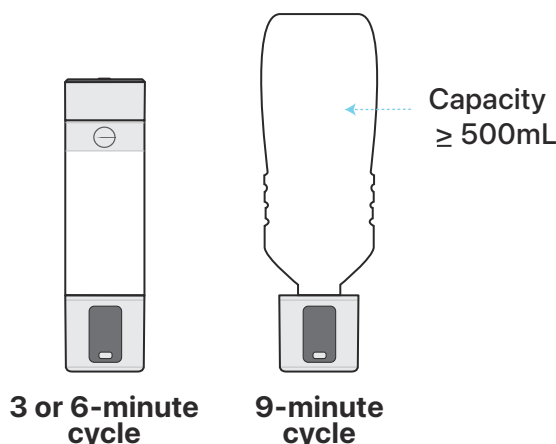

There are three hydrogen production cycles: When using the original container, **ONLY use the 3 or 6-minute cycle** without repeating. The 9-minute cycle should only be used with a larger capacity plastic bottle (500mL, 1L or 1.5L).

CELLPOWER

HYDROGEN WATER BOTTLE



Table of Contents

1. INTRO	3
2. GET STARTED	4
3. CELLPOWER BOTTLE AT A GLANCE	5
3.1 The Lid: How It Operates	6
3.2 The Base: How It Operates	7
3.3 Usage	9
4. CLEANING & MAINTENANCE	9
5. WARNINGS & SAFETY	10
6. WARRANTY	11
7. SPECIFICATIONS	13
8. DISPOSAL	13

*"May you discover a boundless universe
of pure well-being with every sip."*

Nuruning



1. Intro

Thank you for choosing CellPower Hydrogen Water Bottle by LumiVitae.

Please take the time to read this manual carefully and completely BEFORE using the device - its purpose is to guide you through using the product correctly, maintaining it properly, and providing useful tips to optimize your experience.

We are committed to providing you with a convenient and efficient way to enjoy hydrogen-rich water while maintaining ease of use and durability.

If you have any questions or require further assistance, please reach out to our customer support team.

Failure to comply with the instructions provided below may cause damage or malfunction to the product.

This box contains:

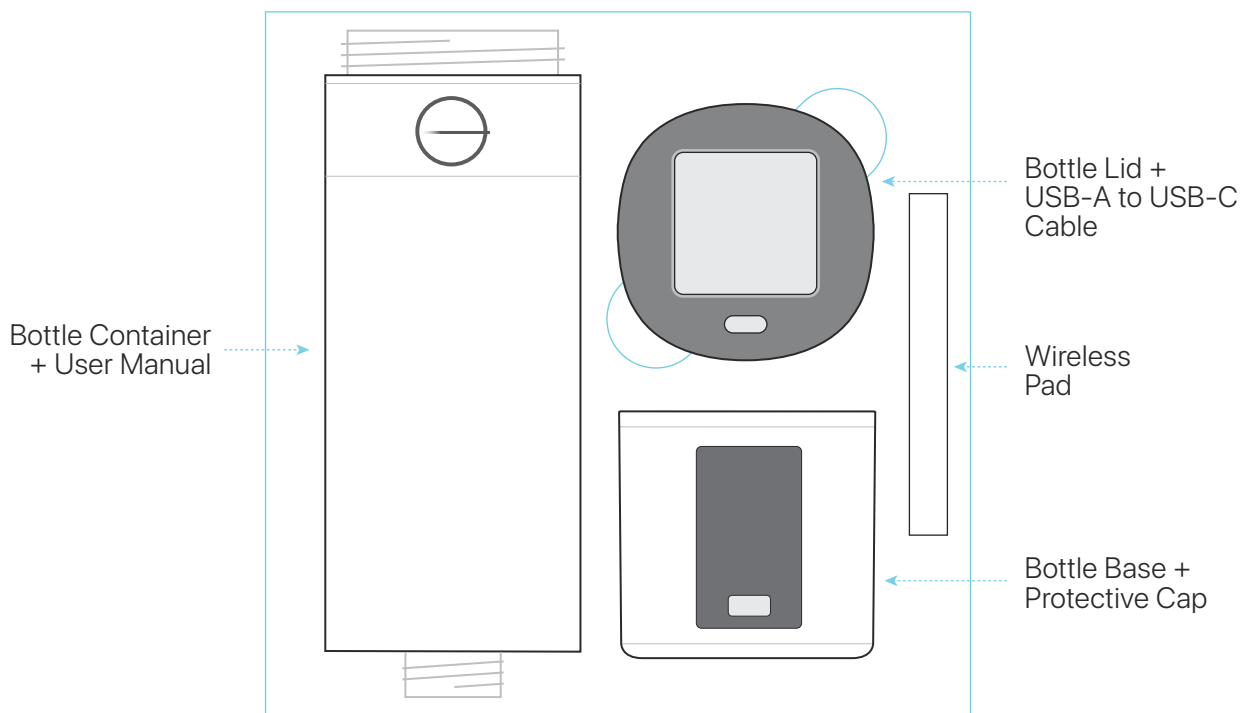



2. Get Started

1

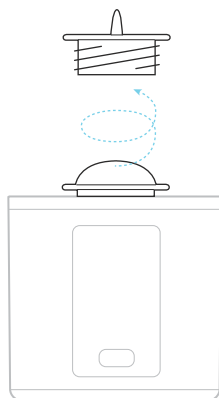

Remove the protective cap from the top of the base.

Unscrew the protective cap to attach the container to the base.

2

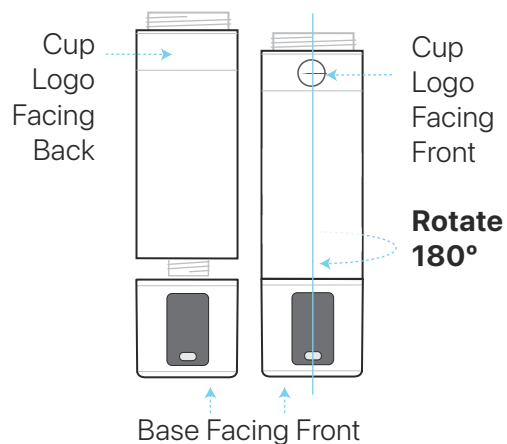

Attach the container to the base.

Position the logo of the cup to the back and rotate the cup on the base by 180 degrees so that it faces the front, aligning with the screen on the base. **Do not force!**

3

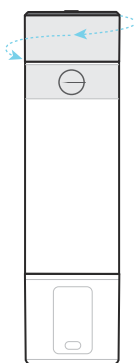

Attach the lid to the container.

Securely attach the lid to the container, ensuring it is aligned properly and tighten it firmly.

4

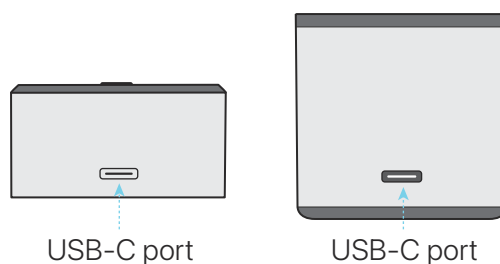

Charge your bottle

The base can be charged either using the Wireless Charging Pad or by connecting the USB-A to USB-C cable to the port at the back. In both cases, a power source is required.

On the other hand, the **lid can only be charged** using the USB-A to USB-C cable.

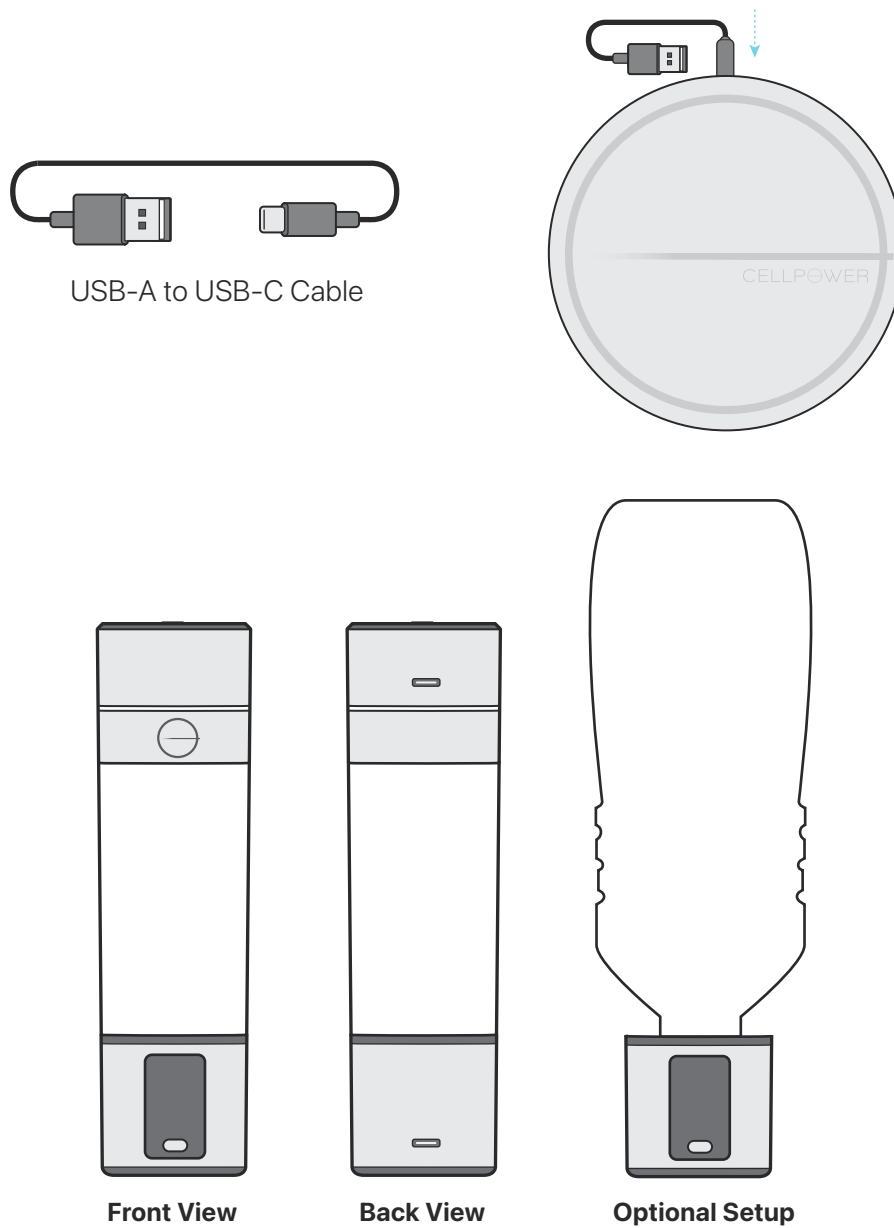

3. CellPower Bottle at a Glance

The CellPower bottle is a device that allows the production of hydrogen-rich water through an electrolysis system, using filtered or bottled drinkable water. Please note that the product generated by this system is not designed or intended to substitute any prescribed medication, therapy, or medical advice. Consult a medical professional if seriously ill or aiming to cure or prevent disease.



3.1 The Lid: How it Operates

Turning On:

To turn on the lid, **press the lid button for 2 seconds**.

Frequency Type Selection:

The start screen prompts you to select the Frequency Type.

To navigate through the menu, **press the button once quickly**.

To confirm your selection, **press the button twice quickly**.

To return to the menu, **press the button once quickly**.



When an option is chosen, an animation will appear on the screen and will remain throughout the entire process or until you decide to interrupt it.



Energy
Animation



Recovery
Animation



LumiVitae
Animation

Shutting Down

When the frequency cycle completes, the lid turns off automatically. To turn off the lid, **long-press** the button when you are on the Menu screen.

Remember, if you press and hold while the animation is running, the lid won't shut down.

Recharging

The lid can only be recharged using the USB-A to USB-C cable.



Lid Back
View

USB-C port



3.2 The Base: How it Operates

Turning On:

To turn on the base, **press the button once quickly**.

Cycles Selection

The start screen displays the selected three-minute cycle, and **it will start immediately**.

To choose a different cycle duration (3-minute, 6-minute, or 9-minute), **press the button once**.

To access this option while in other menus, perform a **long-press of the button**.

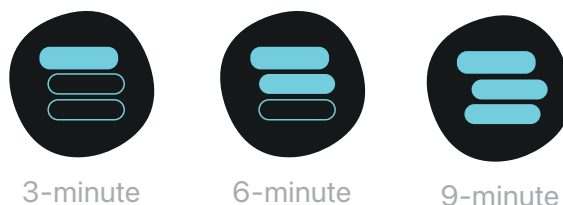
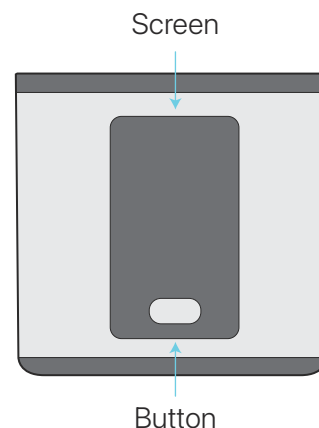

Remember, whenever you switch menus, in any menu, the last displayed option will be the one that stays selected.

Light Selection

Press the button twice quickly to access the color menu, where you can choose the light color.

To cycle through the different options, **press the button once quickly**.

To exit this option, perform a **long-press of the button**.

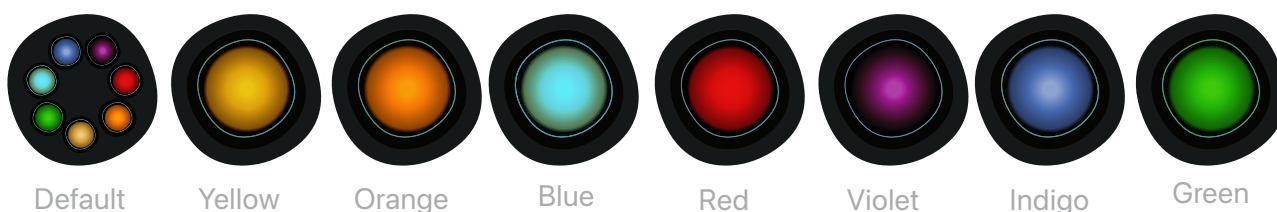

Sound Selection

To turn the sound on and off, **quickly press the button 3 times**.

To cycle through the different options, **press the button once**.

To exit this option, **perform a long-press of the button**.



Shutting Down

When the cycle completes, the base turns off automatically. To turn off the base, **long-press** the button when you are on the Cycles screen.

Remember, if you do a long-press while in any other option, the base won't shut down.

Recharging

The base can be recharged either using the Wireless Charging Pad or by connecting the USB-A to USB-C cable to the port at the back. In both cases, a power source is required.

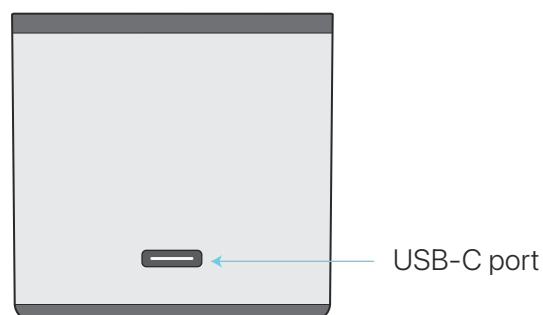



3.3 Usage

- Fill the CellPower bottle with filtered or bottled drinking water up to the lower edge of the aluminum rim. Select the desired programs on both the base and the lid, wait for them to complete, then open the lid and enjoy each sip.
- We recommend water with the following parameters: pH between 5 and 6; TDS (total dissolved solids) between 20-60mg/L.
- Drink the hydrogen-rich water produced within 2 hours, ideally 30 minutes.
- Hydrogen-rich water can be suitable for humans, animals, and plants. There are no specific contraindications for its consumption. If you have any particular health conditions, consult your physician or pharmacist beforehand.
- No side effects are expected upon ingestion. If you experience any symptoms, please contact your physician or pharmacist.

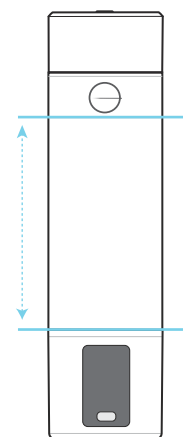

Filtered or Bottled
Drinking Water



4. Cleaning & Maintenance

- No additional maintenance, such as filter changes, is required.
- Promptly clean the device if it comes into contact with substances that may cause stains, like dirt, ink, makeup, food, oils, or lotions.
- Use a soft, dry sponge or cloth for cleaning. Don't use cleaning products or compressed air.
- To eliminate potential odors, unpleasant tastes, or residues, a few drops of lemon can be used.
- Do not place this product in the dishwasher.
- **If the bottle will be unused for more than 1 day**, fill the electrode plate with distilled water and cover it using the protective cap.
- **Over time, the electrode plate may accumulate deposits, reducing its hydrogen-producing effectiveness** - You can check this by observing a decrease in bubble production. To address this, dissolve 15g of food-grade citric acid powder or 15mL of lemon juice in 300ml of warm filtered or bottled water. Pour the solution into the bottle, shake it well, and let it sit overnight. Avoid running hydrogenation cycles during this soaking process. Afterward, thoroughly clean the bottle and run one cycle with clean water to eliminate any remaining acid residue. Discard the produced water.



5. Warnings & Safety

Handle the CellPower bottle with care. It consists of delicate materials, including aluminum and sensitive electronic components. The bottle may incur damage if dropped, punctured, or exposed to excessive force. Avoid contact with liquids other than water, as it can harm the bottle's functionality. Continued use of a damaged bottle, such as one with cracks, may pose risks. For added protection against scratches, consider using a protective case.

- Only use drinkable water in the bottle. Ensure the water source meets recommended standards (filtered or bottled drinkable water). Using an inadequate water source may cause machine malfunction and part deterioration.
- Never operate the generator without water in the bottle.
- Do not use chemicals, organic solvents, strong acids, strong alkalis, or detergents to clean or wipe the CellPower bottle.
- To protect the device and its accessories against contamination and damage keep it closed and away from children, dust, sunlight, moisture, pets and vermin.
- Do not place gasoline or other flammable gases or liquids near the machine or other equipment. Keep away from fire.
- Do not charge or use CellPower in any area with a potentially explosive atmosphere, such as at a fueling area, or in areas where the air contains chemicals or particles (e.g., grain, dust, or metal powders).
- This device is designed to work in ambient temperatures between 32° and 95° F (0° and 35° C) and stored in temperatures between -4° and 113° F (-20° and 45° C). Never place the bottle in environments with extreme temperatures or humidity (e.g., sauna, refrigerator, freezer, etc.) and never submerge it in water or any other liquid (note: it's water-resistant, not waterproof).
- There are three hydrogen production cycles: When using the original container, ONLY use the 3 or 6-minute cycle without repeating. The 9-minute cycle should only be used with a larger capacity plastic bottle (500mL, 1L or 1.5L).
- Only charge with the supplied cable from an USB-Socket with 5V dc and max 2000 mA.
- Charge the device with the included USB-C cable or the wireless pad and other third-party power adapters . Using damaged cables or chargers, or charging when moisture is present, can cause electric shock. Ensure adequate ventilation around power adapters during use.
- Never force a connector into a port or apply excessive pressure to a button, because this may cause damage that is not covered under the warranty. If you encounter difficulty in joining the connector and port, ensure they are compatible and positioned correctly, checking for any obstructions that may be hindering the connection.

- Do not drink from the CellPower Water bottle while it is charging.
- Don't open the device and don't attempt to repair your bottle by yourself. Disassembling CellPower may cause injury to you or damage to the product. If your bottle is damaged or malfunctions contact LumiVitae Customer Support at care@lumivitae.com.
- Don't attempt to replace the CellPower battery yourself—you may damage the battery, which could cause overheating and injury. For information about battery recycling and replacement, contact LumiVitae Customer Support at care@lumivitae.com.
- The device should only be stored and transported under the conditions defined in these instructions.

Disclaimer: This product is not intended to treat, diagnose, mitigate, prevent, or cure disease. Please seek medical advice if you are seriously ill or attempting to cure or prevent any disease.



6. Warranty

Non-Warranty Coverage

The technology embedded within this device is highly sensitive. To ensure both the quality of the product's appearance and its optimal functionality, it is crucial to adhere to the instructions outlined in this manual. The warranty for the product will not apply under the following circumstances:

- If the serial number of the product is unrecognizable, damaged, altered, or removed.
- Damage resulting from non-compliance with the attached instruction manual, improper operation, or incorrect configuration.
- Damage sustained during transportation to our repair center due to inadequate packaging.
- Factors beyond the control of the product itself, such as unstable power supply, inconsistent voltage, or damage caused by force majeure events like fire, flood, earthquake, lightning, or storms.
- Damage caused by using parts not authorized or approved by our company.
- Damage caused by connecting accessories, other products, or peripheral equipment not authorized or approved by our company.
- Damage resulting from disassembly, repair, attachment, or modification not authorized by our company.
- Any malfunction determined by the company that is not inherent to the product itself.

- Any alterations, deletions, or additions to the product's content before maintenance, for which our company will not assume any responsibility. Upon returning the product to the customer, it will be reinstated to its state at the time of purchase.
- For hardware, software, plug-in functions, parts, options, replacements, and accessories provided by third parties not covered by our company's warranty, we will not be liable for any damages incurred during the repair process. Kindly ensure removal of all such components before shipping the product.
- Cosmetic damage, including, but not limited to, scratches, dents, and broken material, except where such damage occurs due to a material or manufacturing defect.
- Defects caused by wear and tear due to normal use or due to the normal aging of the product.
- If LumiVitae is informed by relevant public authorities or records that the product has been stolen.
- If the user cannot in any way prove that they are an authorized user of the product (for example, through a proof of purchase).

Warranty Coverage

Our product offers a comprehensive 2-year warranty service beginning from the date of the invoice. In cases where the product exhibits issues arising from material or manufacturing defects within this period, our company assumes responsibility for repair or replacement. Should your local legislation mandate a longer warranty period than the specified two (2) years at the time of purchase, this warranty will be extended accordingly to comply with such legal requirements.

Determining the Warranty Period

We determine the warranty period for our products based on provided evidence of purchase, which may include invoices or receipts.



7. Specifications

Size	∅ 6cm x 22cm
Weight	550 grs
Capacity	320mL
Materials	Tritan and aluminum
Lid Programs	Energy, Recovery or LumiVitae
Production Cycles	3, 6 or 9 minutes
Light Colors	Yellow, Orange, Blue, Red, Violet, Indigo or Green
Water Temperature	2-99°C



8. Disposal

You must dispose of CellPower bottle properly according to local laws and regulations. Because it contains electronic components and a battery, this device must be disposed of separately from household waste. When CellPower bottle reaches its end of life, contact local authorities to learn about disposal and recycling options.

To contact Lumivitae, Ltd for personalized support:
care@lumivitae.com

